

# VANITY & TOP INSTALLATION GUIDE

## Materials required:

Clear Silicone caulk  
Carpenter's level  
Putty knife  
Sandpaper  
Stud finder  
2 ½- to 3-inch wood screws  
Power drill  
Shims

## Remove the Old Vanity

1. Shut off water at main valve.
2. Turn off waterlines to sink.
3. Remove faucet. CAREFULLY remove old top & cabinet.
4. Clean area. Ensure all old silicone, dirt, etc is cleared.

## Position and Level the New Cabinet

5. Position cabinet on floor or base and level. Shim if necessary.
6. Locate studs in wall behind and attach cabinet with 2 ½- or 3-inch wood screws.
7. DRY FIT Vanity top on cabinet to ensure size and level fit (Image A). Then remove vanity top.

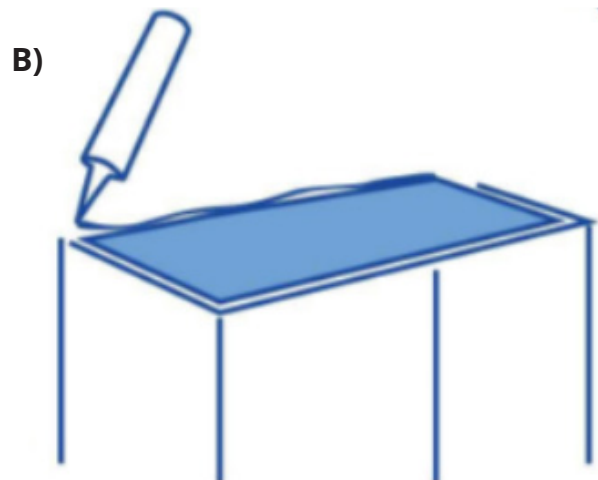
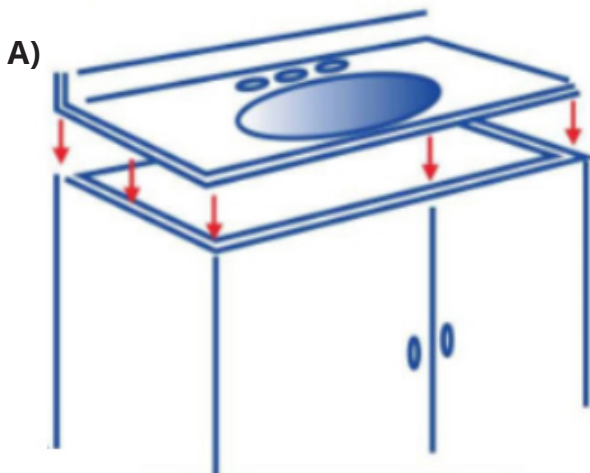

## Install the New Vanity Top

8. Place silicone to the top edge of the cabinet (Image B).
9. Place vanity top carefully on top of cabinet and press firmly to secure.
10. Place silicone on the back of the backsplash and install.
11. Wipe excess silicone and let dry.

**\*\*\*Once your Cabinet and Top have been installed it is important to make adjustments to your Doors and Drawer Fronts as they can be miss-aligned during transportation.**

**Please see the instructions for Door Adjustment and Drawer Front Adjustment on the reverse of this sheet.\*\*\***

## CLIP-TOP BLUMOTION

Three-dimensional adjustment

### SIDE TO SIDE ADJUSTMENT

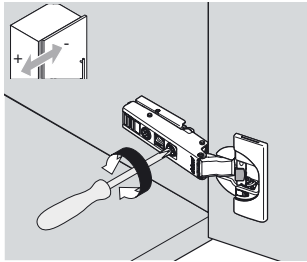

Using a phillips head screwdriver, turn the adjustment screw clockwise and counter clockwise to move the door - the direction of turn and it's effect is dependent on which side of the door the hinge is attached.

### HEIGHT ADJUSTMENT

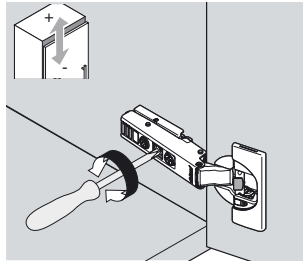

This adjustment involves two screws, one to the top and one to the bottom of the clip. Loosen the screws slightly and then lift or lower the door until it is in the position you want. Re-tighten the screws to secure the door.

### DEPTH ADJUSTMENT

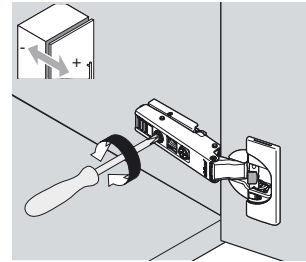

Use this screw to adjust how far out or in the doors are in comparison to your cabinet and to the other cabinet doors and drawers surrounding it. Loosen the screw and manually push or pull the door to adjust it. Re-tighten the screw when the door is in the position you want.

## BLUMOTION METABOX DRAWER

Adjustment

### DRAWER FRONT HEIGHT ADJUSTMENT



This adjustment involves two front fixing brackets. Each front fixing bracket has two screws, one at the top and one at the bottom.  
Step 1) Loosen the top screws slightly.  
Step 2) Use the bottom screws to adjust the height of the drawer front.  
Step 3) Re-tighten the top screws to secure the drawer front in place.

## INTERO DRAWER

Two-dimensional adjustment

### SIDE TO SIDE ADJUSTMENT



Using a phillips head screwdriver, turn the front adjustment screw clockwise and counter clockwise to move the drawer.

### HEIGHT ADJUSTMENT



Using a phillips head screwdriver, turn the rear adjustment screw clockwise and counter clockwise to move the drawer.

## DOVETAIL DRAWER

Adjustment

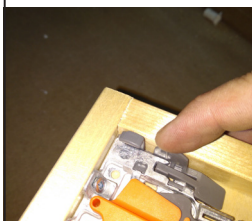

### HEIGHT ADJUSTMENT

Step 1) Underneath the dovetail drawer, locate the Blum dovetail clip.  
Step 2) Press small grey tab in and slide forward for height adjustment (up to 2mm in each direction). See attached photo for tab location.

### SIDE TO SIDE ADJUSTMENT

Step 1) Pull open drawer.  
Step 2) From the inside of the drawer, unscrew the back of the drawer front.  
Step 3) Adjust the front left/right (can also adjust up/down at this point as well).  
Step 4) Tighten drawer front.

*\*Drawer fronts can only move +/- 2mm height and side to side. Anything more than that, the front needs to be removed from the Dovetail box by removing the screws, realign, and then screw back onto dovetail.*